

Housing recommendation

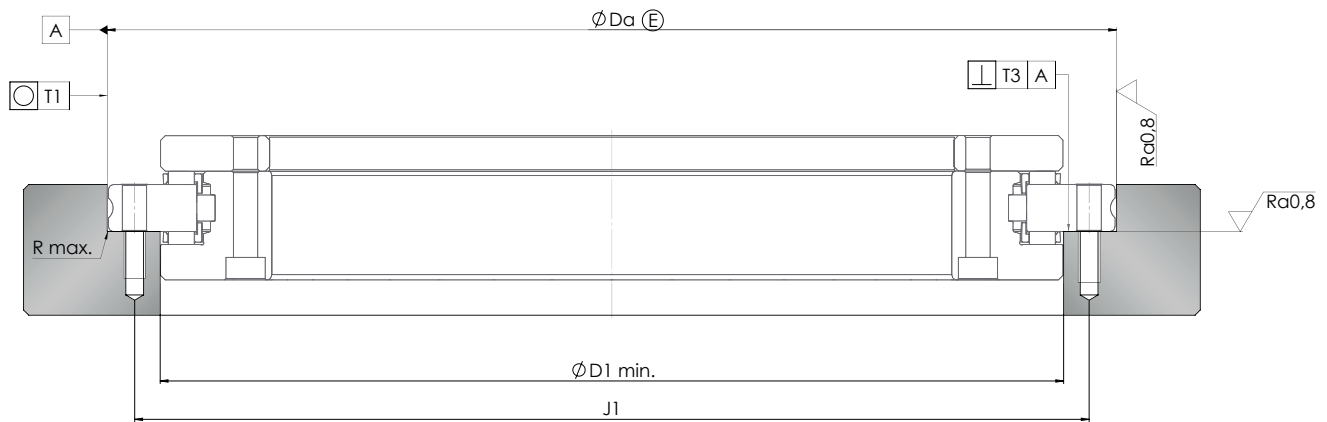

¹⁾ The envelope condition E applies here.

²⁾ Note the countersinking of the threads.

³⁾ Note the bearing diameter D_1 in the drawing or the data sheet. Ensure that there is sufficient distance between the rotating bearing rings and the adjacent construction.

⁴⁾ It is possible to dispense with a fit in the housing or alternatively to choose a G7 fit.

Bearing	Diameter ¹⁾			Pitch circle ²⁾	Shoulder diameter ³⁾	Roundness	Perpendicularity	Max. corner radius
	ϕD_a [mm]	stationary outer ring: Tolerance G7 ⁴⁾ [mm]	rotating outer ring: Tolerance J6 [mm]	J1 [mm]	$\phi D_1 \text{ min.}$ [mm]	T1 [μm]	T3 [μm]	Rmax. [mm]
AXRY 180-NGX	280	0,069 0,017	0,025 -0,007	260	244,5	8	8	0,1
AXRY 200-NGX	300	0,069 0,017	0,025 -0,007	285	274,5	8	8	0,1
AXRY 260-NGX	385	0,075 0,018	0,029 -0,007	365	345,5	9	9	0,3
AXRY 325-NGX	450	0,083 0,020	0,033 -0,007	430	415,5	10	10	0,3
AXRY 395-NGX	525	0,092 0,022	0,034 -0,010	505	486,5	11	11	0,3
AXRY 460-NGX	600	0,092 0,022	0,034 -0,010	580	561	11	11	0,3
AXRY 580-NGX	750	0,104 0,024	0,038 -0,012	720	701	13	13	1
AXRY 650-NGX	870	0,116 0,026	0,044 -0,012	830	801	15	15	1