

Dimensions table AXRY-NGS

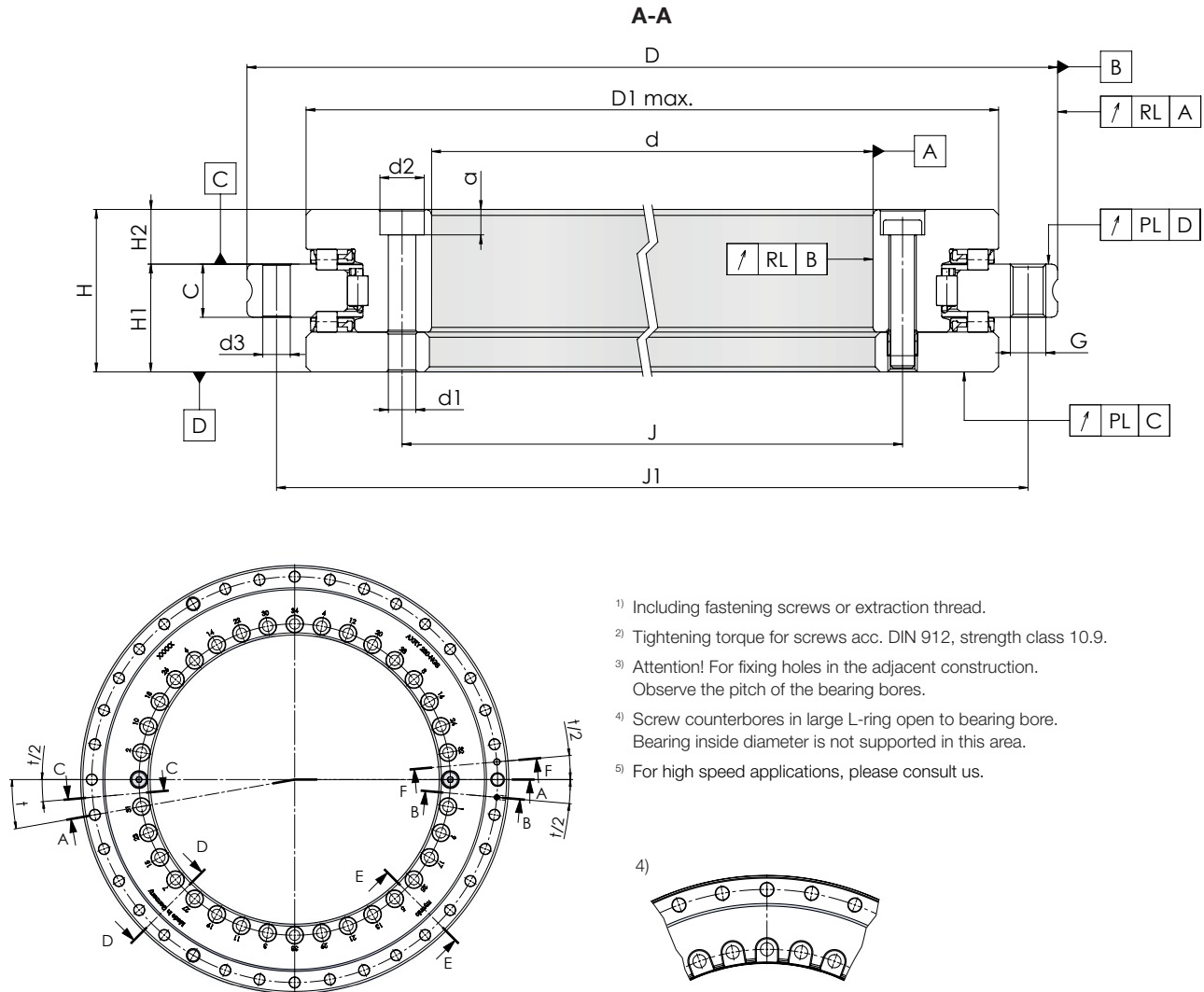

- 1) Including fastening screws or extraction thread.
- 2) Tightening torque for screws acc. DIN 912, strength class 10.9.
- 3) Attention! For fixing holes in the adjacent construction. Observe the pitch of the bearing bores.
- 4) Screw counterbores in large L-ring open to bearing bore. Bearing inside diameter is not supported in this area.
- 5) For high speed applications, please consult us.

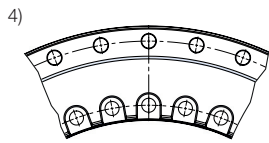

Designation	Mass [kg]	Dimensions [mm]														
		d	tol. d	D	tol. D	H	H1	tol. H1	tol. H1	H2	tol. H2	tol. H2	C	D1	J	J1
								standard	restricted		standard	restricted		max		
AXRY 120-NGS	4,5	120	-0,010	210	-0,015	40	26	± 0,025	-	14	± 0,2	± 0,025	12	184	135	195
AXRY 200-NGS	9,0	200	-0,015	300	-0,018	45	30	± 0,03	-	15	± 0,2	± 0,025	15	274	215	285
AXRY 260-NGS	17,1	260	-0,018	385	-0,020	55	36,5	± 0,04	-	18,5	± 0,2	± 0,025	18	345	280	365
AXRY 325-NGS ⁴⁾	23,9	325	-0,023	450	-0,023	60	40	± 0,05	-	20	± 0,2	± 0,025	20	415	342	430
AXRY 395-NGS	31,6	395	-0,023	525	-0,028	65	42,5	± 0,05	-	22,5	± 0,2	± 0,025	20	486	415	505
AXRY 460-NGS	42,4	460	-0,023	600	-0,028	70	46	± 0,06	-	24	± 0,2	± 0,03	22	560	482	580
AXRY 580-NGS	84,8	580	-0,025	750	-0,035	90	60	± 0,25	± 0,075	30	± 0,3	± 0,03	30	700	610	720
AXRY 650-NGS	162,3	650	-0,038	870	-0,050	122	78	± 0,25	± 0,1	44	± 0,3	± 0,03	34	800	680	830

Available option design - SBI
ordering code - SBI

B-B*
(1x lubrication bore)

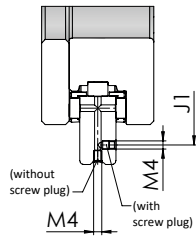

Note:*

In the case of axial lubrication, please remove the screw plug and seal off the radial lubrication!

C-C
(1x sensor bore)

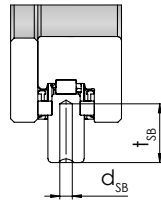

F-F
(1x positioning bore)

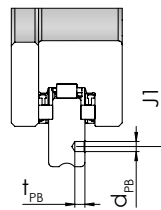

B-B
(1x lubrication bore)

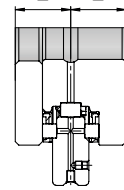

C-C
(1x sensor bore)

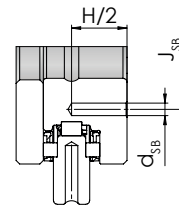

D-D
(2x 180° lubrication bore)

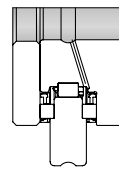

E-E
(2x 180° lubrication bore)

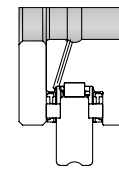

Designation	Fixing holes									Positioning hole		Sensor bore			
	Inner ring				Outer ring				Number x Pitch	Screw tightening torque	Diameter	Depth	Pitch circle diameter	Diameter	Depth
	d1	d2	a	Number ⁽³⁾	d3	Number ⁽³⁾	Extraction thread	G							
AXRY 120-NGS	7	11	6,4	22	7	21	M8	3	24x 15°	14	5	5	140,8	3,2	21
AXRY 200-NGS	7	11	6,4	46	7	45	M8	3	48x 7,5°	14	5	5	228	3,2	20,4
AXRY 260-NGS	9,3	15	8,6	34	9,3	33	M12	3	36x 10°	34	5	5	290,8	6,2	29
AXRY 325-NGS⁽⁴⁾	9,3	15	8,6	34	9,3	33	M12	3	36x 10°	34	5	5	360,8	6,2	26,6
AXRY 395-NGS	9,3	15	8,6	46	9,3	45	M12	3	48x 7,5°	34	5	5	431,2	6,2	28,8
AXRY 460-NGS	9,3	15	8,6	46	9,3	45	M12	3	48x 7,5°	34	5	5	503,8	6,2	29,1
AXRY 580-NGS	11,4	18	10,6	46	11,4	42	M12	6	48x 7,5°	68	8	8	628,6	6,2	39,7
AXRY 650-NGS	14	20	12,6	46	14	42	M12	6	48x 7,5°	116	10	10	706,2	6,2	56,9

Designation	Load ratings				Rigidity of the bearing position			Limiting speed ⁽⁵⁾	Axial runout & radial runout		Mass moment of inertia	
	Axial		Radial		Axial	Radial	Tilting		standard	restricted	rotating outer ring	rotating inner ring
	dyn. C _a [kN]	stat. C _{0a} [kN]	dyn. C _r [kN]	stat. C _{0r} [kN]	C _{al} [kN/μm]	C _{rl} [kN/μm]	C _{kl} [kNm/mrad]	n _G [min ⁻¹]	PL & RL [μm]	PL & RL [μm]	M _{MA} [kg * cm ²]	M _{MI} [kg * cm ²]
AXRY 120-NGS	100,4	484,7	40,1	82,8	4,1	1,9	14,2	2150	3	1,5	93	115
AXRY 200-NGS	159,2	901,8	93,5	226,2	6,6	3,5	53,1	1600	4	2	444	602
AXRY 260-NGS	178,7	1127,3	110,1	303,5	8,8	4,6	114,8	1200	6	3	1646	1787
AXRY 325-NGS⁽⁴⁾	188	1277,6	115,6	345,4	10,3	5,2	193,4	1000	6	3	2787	4035
AXRY 395-NGS	212,5	1578,2	154,1	529,8	12,9	7,2	337,5	800	6	3	4786	7470
AXRY 460-NGS	190,9	1427,9	177,1	605,6	12,9	7,5	455,1	700	6	3	8130	14695
AXRY 580-NGS	484,7	3492,7	251,6	867,2	16,9	8,8	917,2	500	10	5	28467	42140
AXRY 650-NGS	816,3	5829,1	406,6	1317,1	20,3	9,8	1451,2	400	10	5	68641	97690