

## Housing recommendation

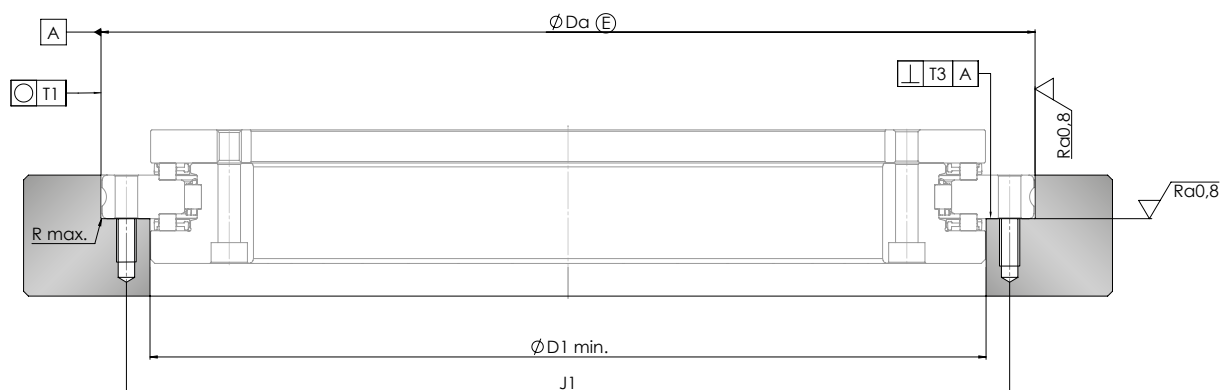

<sup>1)</sup> The envelope condition  $\textcircled{E}$  applies here.

<sup>2)</sup> Note the countersinking of the threads.

<sup>3)</sup> Note the bearing diameter D1 in the drawing or the data sheet. Ensure that there is sufficient distance between the rotating bearing rings and the adjacent construction.

<sup>4)</sup> It is possible to dispense with a fit in the housing or alternatively to choose a G7 fit.<sup>5)</sup>

### Running accuracy requirements:

- For maximum running accuracy and a rotating outer ring, a fit clearance of  $0\mu\text{m}$  should be aimed for.
- For normal running accuracy or rotating outer ring, design the housing according to the tolerance table.

### Requirements for the dynamic properties:

- For swiveling operation and rotating outer ring, design the housing according to the tolerance table.
- At higher speeds and longer duty cycles with rotating outer ring, an interference fit of  $5\mu\text{m}$  is not possible exceed.
- A clearance of  $0\mu\text{m}$  should be aimed for for the highest speeds and longer duty cycles with rotating outer ring. Tendency easily into play. Requirement for this is the pairing of bearing and shaft. Actual bearing dimension can be found in the bearing report.

Bearing	Diameter <sup>1)</sup>			Pitch circle <sup>2)</sup>	Shoulder diameter <sup>3)</sup>	Roundness	Perpendicularity	Max. corner radius
	$\phi Da$ [mm]	stationary outer ring: Tolerance G7 <sup>4)</sup> [mm]	rotating outer ring: Tolerance <sup>5)</sup> [mm]					
AXRY 120-NGS(-SBI)	210	0,061 0,015	0,007 -0,005	195	185,5	4	6	0,1
AXRY 180-NGS(-SBI)	280	0,069 0,017	0,011 -0,005	260	244,5	5	7	0,1
AXRY 200-NGS(-SBI)	300	0,069 0,017	0,011 -0,005	285	274,5	6	8	0,1
AXRY 260-NGS(-SBI)	385	0,075 0,018	0,013 -0,005	365	345,5	6	8	0,3
AXRY 325-NGS(-SBI)	450	0,083 0,020	0,015 -0,005	430	415,5	6	8	0,3
AXRY 395-NGS(-SBI)	525	0,092 0,022	0,017 -0,005	505	486,5	6	8	0,3
AXRY 460-NGS(-SBI)	600	0,092 0,022	0,017 -0,005	580	561	6	8	0,3
AXRY 580-NGS(-SBI)	750	0,104 0,024	0,019 -0,005	720	701	8	10	1
AXRY 650-NGS(-SBI)	870	0,116 0,026	0,021 -0,005	830	801	8	10	1